

STAN HOWE CONFERENCE CENTER

6TH Floor

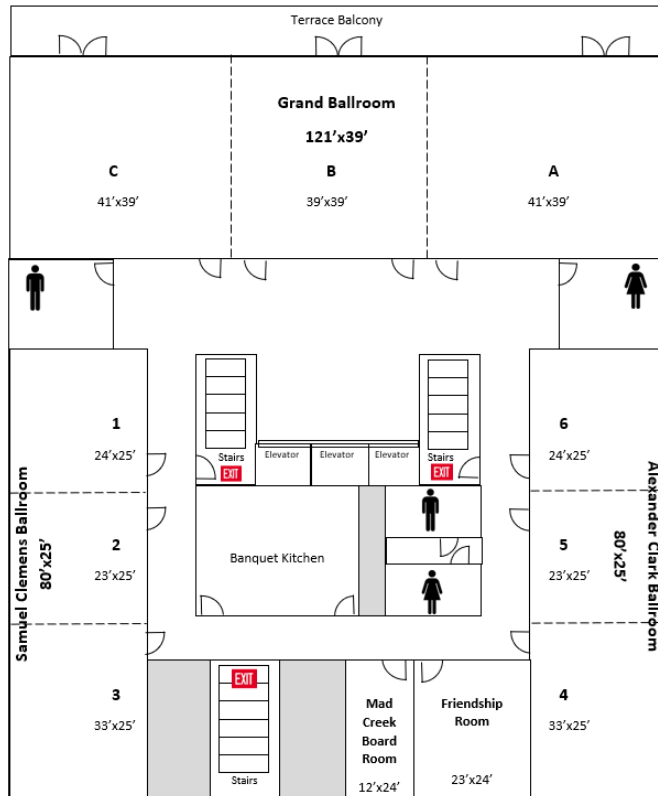

119 W. Mississippi Drive, Muscatine, Iowa 52761
 (563) 263-2600 or toll free (833) 261-2600
www.theMerrill.com Info@themerrill.com

EXECUTIVE MEETING ROOMS

5th Floor

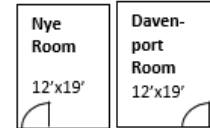
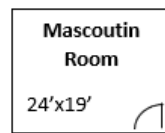

FUNCTION CAPACITIES

	Sq. Ft.	Room Size	Ceiling	Rounds of 10	Classroom	Theater	Conference	U-Shape	H-Square	Reception
Grand Ballroom	4719	121'x39'	15'	360	280	470	150	NA	NA	525
Ballroom A	1599	41'x39'	15'	125	95	160	50	45	50	180
Ballroom B	1521	39'x39'	15'	110	90	150	50	45	50	165
Ballroom C	1599	41'x39'	15'	125	95	160	50	45	50	180
Clark Ballroom	2000	80'x25'	15'	150	120	200	65	55	65	225
Clark 1	600	24'x25'	15'	45	35	60	20	15	20	70
Clark 2	575	23'x25'	15'	45	35	60	20	15	20	65
Clark 3	825	33'x25'	15'	60	50	80	25	25	25	90
Clemens Ballroom	2000	80'x25'	15'	150	120	200	65	55	65	225
Clemens 4	825	33'x25'	15'	60	50	80	25	25	25	90
Clemens 5	575	23'x25'	15'	45	35	60	20	15	20	65
Clemens 6	600	24'x25'	15'	45	35	60	20	15	20	70
Friendship Room	552	23'x24'	15'	40	30	55	15	10	15	60
Mad Creek Boardroom	288	12'x24'	15'	NA	NA	NA	10	NA	NA	NA
Mascoutin Boardroom	456	24'x19'	9'	NA	NA	NA	15	NA	NA	NA
Nye Boardroom	228	12'x19'	9'	NA	NA	NA	8	NA	NA	NA
Davenport Boardroom	247	13'x19'	9'	NA	NA	NA	8	NA	NA	NA