

# STAN HOWE CONFERENCE CENTER

## 6<sup>TH</sup> Floor

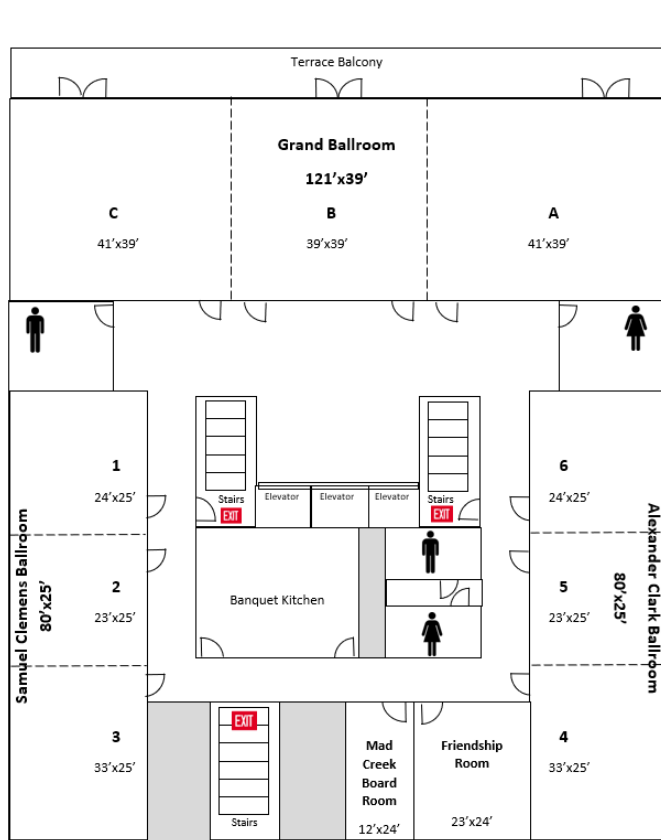

119 W. Mississippi Drive, Muscatine, Iowa 52761  
 (563) 263-2600 or toll free (833) 261-2600  
[www.theMerrill.com](http://www.theMerrill.com) [Info@themerrill.com](mailto:Info@themerrill.com)

### EXECUTIVE MEETING ROOMS 5<sup>th</sup> Floor

**Mascoutin Room**  
24'x19'

**Nye Room**  
12'x19'

**Davenport Room**  
12'x19'

## FUNCTION CAPACITIES

	Sq. Ft.	Room Size	Ceiling	Rounds of 10	Classroom	Theater	Conference	U-Shape	H-Square	Cocktail Reception
<b>Grand Ballroom</b>	4719	121'x39'	15'	360	280	470	150	NA	NA	525
<b>Ballroom A</b>	1599	41'x39'	15'	125	95	160	50	45	50	180
<b>Ballroom B</b>	1521	39'x39'	15'	110	90	150	50	45	50	165
<b>Ballroom C</b>	1599	41'x39'	15'	125	95	160	50	45	50	180
<b>Clark Ballroom</b>	2000	80'x25'	15'	150	120	200	65	55	65	225
<b>Clark 1</b>	600	24'x25'	15'	45	35	60	20	15	20	70
<b>Clark 2</b>	575	23'x25'	15'	45	35	60	20	15	20	65
<b>Clark 3</b>	825	33'x25'	15'	60	50	80	25	25	25	90
<b>Clemens Ballroom</b>	2000	80'x25'	15'	150	120	200	65	55	65	225
<b>Clemens 4</b>	825	33'x25'	15'	60	50	80	25	25	25	90
<b>Clemens 5</b>	575	23'x25'	15'	45	35	60	20	15	20	65
<b>Clemens 6</b>	600	24'x25'	15'	45	35	60	20	15	20	70
<b>Friendship Room</b>	552	23'x24'	15'	40	30	55	15	10	15	60
<b>Mad Creek Boardroom</b>	288	12'x24'	15'	NA	NA	NA	10	NA	NA	NA
<b>Mascoutin Boardroom</b>	456	24'x19'	9'	NA	NA	NA	15	NA	NA	NA
<b>Nye Boardroom</b>	228	12'x19'	9'	NA	NA	NA	8	NA	NA	NA
<b>Davenport Boardroom</b>	247	13'x19'	9'	NA	NA	NA	8	NA	NA	NA